

DCV500 'VERTICAL LIFT' DRUM CLAMP



The DCV500 drum clamp has been designed to lift and transport steel drums in the vertical position. One clamp can be used to lift drums with or without their lids by gripping the rim of the drum.

Its light weight and small overall design makes it ideal for picking up drums that sit tightly on pallets. The centre of gravity of the drum is below the lifting point during transportation.

The DVC500 is also available with a 'lock on / open latch'. Please contact the Camlok sales team for further details.

NB: For use with STEEL DRUMS only.

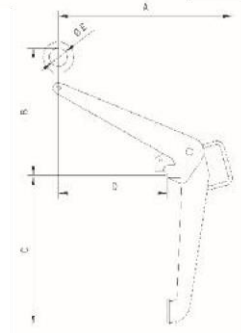

Model	WLL kg	A mm	B mm	C mm	D mm	E mm	Weight kg*
DCV500	500	479	350	410	300	50	7

*Per clamp.