

## DESCRIPTION

The Camlok TSB series of wide jaw gentle grip plate lifting clamps has a hard rubber lined clamping jaw and can be used on all structural steel plates, timber, plastics and sections that must not be marked. This clamp can lift and turn material from the horizontal to the vertical and back to the horizontal position through 180° and vice versa.

## DIAGRAM

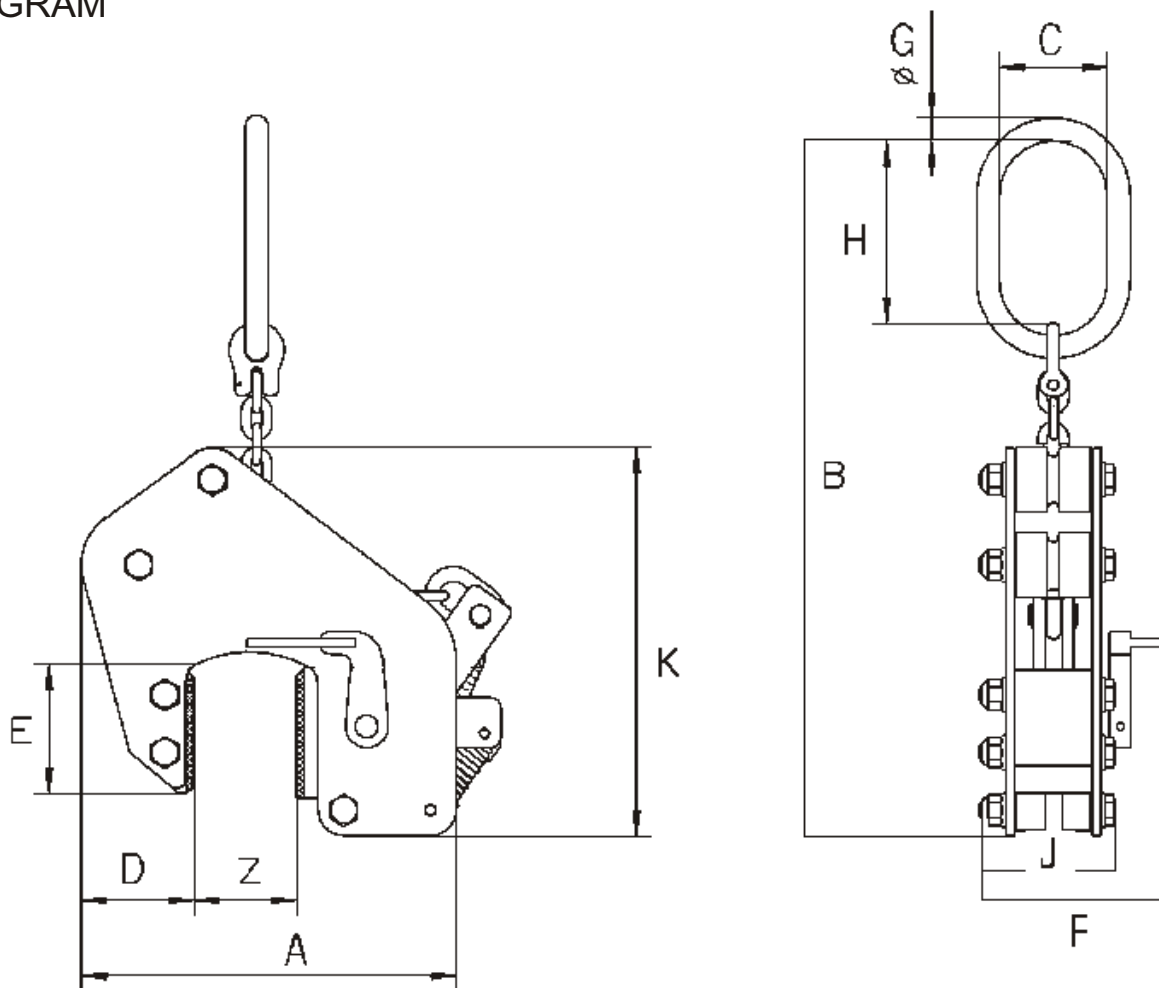

## TABLE

MODEL	WLL Tons	Jaw mm Z	Weight kg	A	B Max/min	C	D	E	F	G	H	J	K
TSB0,35	0,35	0 - 65	8	260	700-500	128	78	100	90	18	125	78	270
TSB0,75	0,75	0 - 65	9	260	700-500	128	78	100	90	18	125	78	270
TSB1,25	1,25	0 - 65	12	280	700-500	128	78	100	90	18	125	78	320

### Load Diagram with slings vertical

Loads weighing the maximum W.L.L may be lifted and turned through 180 degrees in the plane of the clamp

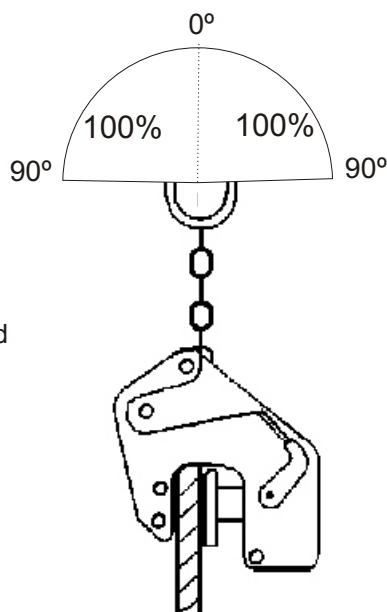

Loads weighing the maximum W.L.L may be lifted through 15 degrees in the plane of the clamp

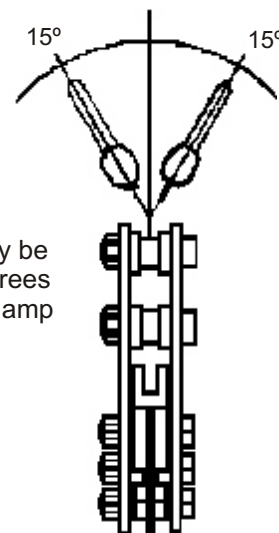

### RESTRICTIONS

The working load limit of the clamp should be as close as possible to the actual load to be lifted. This ensures that the clamp is working at maximum efficiency. Loads below 10% of the working load limit should be avoided extra care must be taken when lifting plates in the lower 20% of the rated jaw capacity. The TSB clamp is not suitable for use in temperatures above 80°C. Pads must be inspected weekly for damage.

#### FOR SHORT PLATES

A single clamp can be used

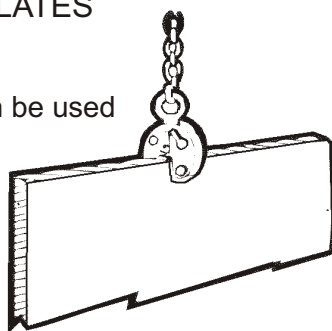

#### FOR LONG PLATES

2 clamps and a lifting beam must be used

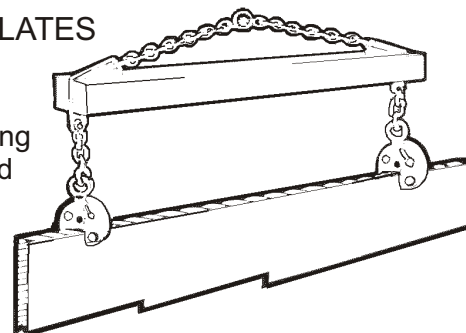

### OPTIONS

There are several options available in the TSB gentle grip range of clamps to cover various applications including size and jaw capacity. For more information contact our sales team.

